

gentoo

PRODUCT DATA SHEET

Denver medium curved complete reception unit - beech with white panels

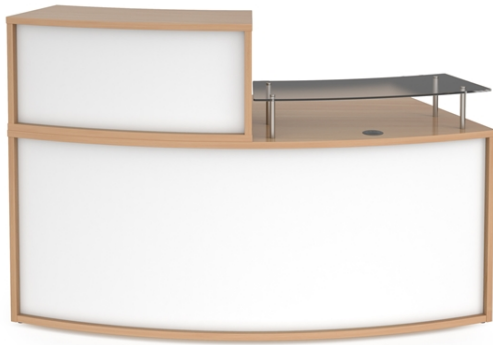

DVB02-BWH

The reception area is of critical importance for any business. It needs to be a welcoming space for all visitors, from valued customers to prospective new starters arriving for an interview. Available in beech with optional white panels, Denver is a flexible modular unit that can be arranged in a variety of configurations with the base and top units to create a commanding reception feature that will make a lasting first impression.

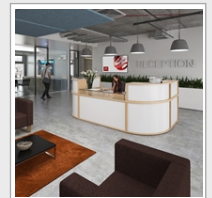

PRODUCT FEATURES

- Complete Denver reception unit - curved medium sized
- Contains: 1 x RUHC8H - 450 curved top unit 915mm, 1 x RU8GS-C - Curved glass shelf 910mm, 1 x RUHC18D - 450
- Available in beech and beech with white panels
- 25mm melamine beech surfaces which are scratch and heat resistant
- Adequate storage so the area appears uncluttered and there's plenty of room to work
- Simple cam and pin construction with adjustable height levelling feet

DIMENSIONS & SPECIFICATIONS

Height	Width	Depth
1172mm	1800mm	800mm

RRP: £1,203.00
Bar Code: 5019904464912
Conforms to:

Colour: Beech/White
Warranty: 5 years

Pack Quantity: 1
Weight (Kg):